

6. PARTS LIST

1.Point Tool (standard) EW-101 *Consumable Accessory
(Fine) EW-101-B *Option
(Bold) EW-101-C *Option

2.Bush EW-102

3.O-Ring EW-103

4.Front Housing EW-104

5.Front Spring EW-105

6.O-Ring (7.66×1.78) EW-106

7.O-Ring (12.1×1.6) EW-107

8.O-Ring (2.5×1.8) EW-108

9.Valve Ball EW-109

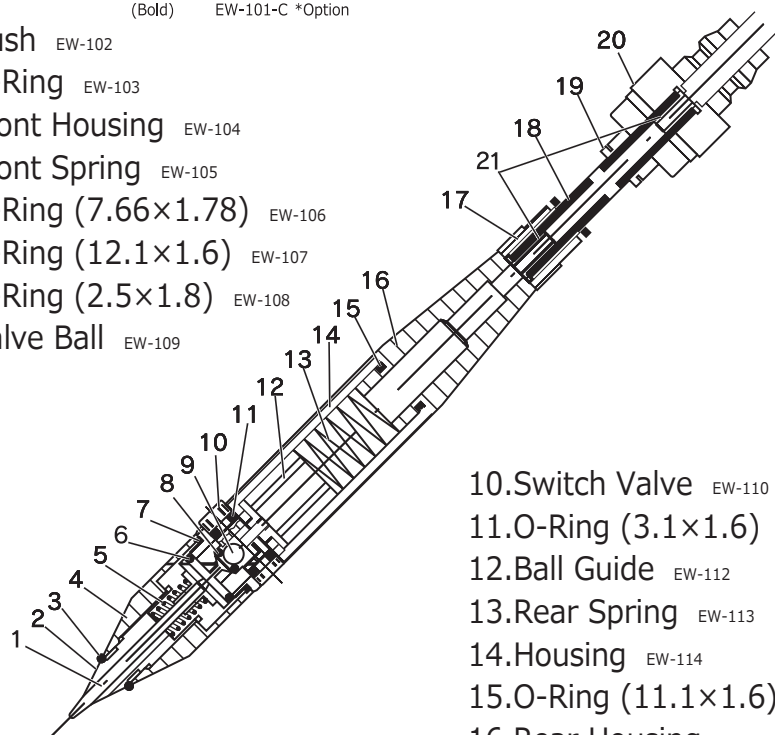

10.Switch Valve EW-110

11.O-Ring (3.1×1.6) EW-111

12.Ball Guide EW-112

13.Rear Spring EW-113

14.Housing EW-114

15.O-Ring (11.1×1.6) EW-115

16.Rear Housing EW-116

17.Hose Connector M7 EW-117

18.Air Hose Black 2.5m EW-118

19.Hose Connector 1/4 EW-119

20.Coupler EW-120

21.Bronze Bush EW-121

INSTRUCTION MANUAL

EW-01

WORK MARKER

Read following instructions before attempting to use.

Keep this manual always in the vicinity of use for your reference.

Before using the unit, check if there are any damages on the unit due to transport conditions. If any damages are found, contact our Minimo dealer.

SAFETY PRECAUTIONS

⚠ WARNING

(Indicates that incorrect operations presents significant danger of accident resulting in death or serious injury to the user.)

- Wear an appropriate eye protection and a respiratory protective equipment when using the handpiece.
- Use compressed air with the pressure 4 ~ 7 kgf / cm² (56 ~ 99psi)
- Do not attempt to disassemble and remodel the unit.
- Do not touch the point tool when vibrating.

⚠ CAUTION

(Indicates that incorrect operation presents possibility of injury to the user or damage to the unit.)

- Never push the point tool hard onto the workpiece.
Excessive force on the tool will cause damage to the tool and also reduce the cutting power.
- Use air filter and/or dryer to eliminate water, water vapor and any other dust particle in compressed air.
- Avoid any heavy impact to the unit. Do not drop it!
- Keep the unit away from children.

MINITOR CO., LTD. JAPAN

21-1 Ryogoku 3-chome, Sumida-ku, Tokyo 130-0026 JAPAN

Phone +81 3 (6630) 5800 FAX +81 3 (6630) 5795

Products are subject to change without notice.

1. PACKING LIST

- ◇ WORK MARKER (EW-01) with air hose 1 PC.
- ◇ Instruction Manual 1 PC.

2. FEATURE

- * To engrave on hardened metals with hardness less than 50 by HRC, glass, plastic, etc.
- * The point tool is made of tungsten carbide, and easy to replace.
Fine type and bold type are also available as options.

3. SETTING

- 1) Make sure that the switch valve is off.
- 2) Connect the coupler to air compressor while the switch valve is in off position.
※Caution : Never connect the coupler to an air compressor while the switch valve is "ON" .
It may cause an unexpected accident.

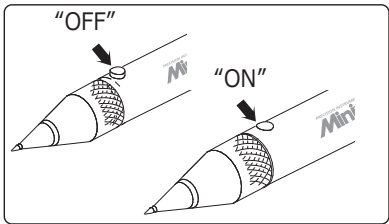

4. HOW TO USE

- 1) Push the switch valve on to start.
- 2) Hold the handpiece as close to the point as possible and engrave in condition of handpiece close to vertical position.
- 3) Push the switch valve off to stop.

5. MAINTENANCE

5-1. Lubrication

Lubricate with supplying air from the end of hose once a day or more depending on frequency in use.

5-2. Replacing the point tool

- 1) Hold the center part of the housing, and turn the front housing to loosen. If it is too hard to turn, clamp the housing softly by a small vise and try to turn it loose.

* Do not clamp the housing too hard. The housing may be broken.

- 2) Pull out the point tool from the front housing.

Mount the O-ring and the front spring on the new point tool as in the right figure

- 3) Put the new point tool into the front housing and tighten the front housing back to the housing.

* Replace to our genuine parts for right characteristics and dimensions.

* Prevent from entering foreign substances into the housing when replacing the tool and/or other parts.

