

INSTRUCTION MANUAL

BS31 MINI BELTSANDER

READ FOLLOWING INSTRUCTIONS THOROUGHLY BEFORE ATTEMPTING TO USE.
 ALSO READ THE INSTRUCTION MANUAL OF THE HEAD PART AS WELL.
 KEEP THIS MANUAL ALWAYS IN THE VICINITY OF USE FOR YOUR REFERENCE.
 BEFORE USING THE UNIT, CHECK IF THERE ARE ANY DAMAGES ON THE UNIT DUE TO
 TRANSPORT CONDITIONS. IF ANY DAMAGES ARE FOUND, CONTACT OUR MINIMO DEALER.

SAFETY PRECAUTIONS

- ⚠ WARNING** (INDICATES THAT INCORRECT OPERATION PRESENTS SIGNIFICANT DANGER OF ACCIDENT RESULTING IN DEATH OR SERIOUS INJURY TO THE USER.)
- WEAR AN APPROPRIATE EYE PROTECTION AND A DUST PROTECTING MASK WHEN USING THE HANDPIECE.
 - TURN OFF THE MAIN SWITCH IMMEDIATELY AND UNPLUG THE AC CABLE WHEN ONE OR MORE OF THE FOLLOWINGS ARE RECOGNIZED. SMOKING; NASTY SMELL; STRANGE NOISE.
 - DO NOT DISASSEMBLE AND REMODEL THE UNIT. ANY ACCIDENT OR MALFUNCTION CAUSED BY DISASSEMBLING AND/OR REMODELING WILL NOT BE COVERED BY OUR RESPONSIBILITY.
 - IT GENERATES SPARKS INSIDE THE MOTOR WHEN IT IS RUNNING. NEVER USE THE UNIT WHERE INFLAMMABLE AND/OR EXPLOSIVE GASES MAY EXIST.
 - WHEN TURNING ON THE POWER SWITCH, HOLD THE HANDGRIP FIRMLY.
 - DO NOT TOUCH ANY REVOLVING BODIES SUCH AS ABRASIVE BELT AND PULLEYS.

- ⚠ CAUTION** (INDICATES THAT INCORRECT OPERATION PRESENTS POSSIBILITY OF INJURY TO THE USER OR DAMAGE TO THE UNIT.)
- DO NOT USE THE UNIT IN EXCESSIVELY HUMID PLACE. THE CONDENSATION OF VAPOR ON AND/OR INSIDE OF THE UNIT CAUSES A MALFUNCTION OF THE UNIT, A SHORT CIRCUIT, FIRE OR AN ELECTRIC SHOCK
 - DO NOT USE THE UNIT WHERE CORROSIVE GASES AND CHEMICALS POSSIBLY EXIST.
 - THE AMBIENT TEMPERATURE SHOULD BE IN THE RANGE OF 0° ~ 40° C
 - KEEP THE UNIT AWAY FROM CHILDREN.
 - AVOID ANY HEAVY SHOCK TO THE UNIT. DO NOT DROP!
 - KEEP ALL LIQUIDS SUCH AS OIL, WATER, AND ETC. OFF THE UNIT. THIS MAY CAUSE A MALFUNCTION OF THE UNIT, CATCH FIRE AND/OR GET AN ELECTRIC SHOCK.
 - CONNECT THE GREEN LINE ON THE POWER CABLE TO THE GROUND. STATIC MAY GENERATE

<REPLACING THE ARMPAD>

THE ARMPAD IS EXCHANGEABLE. JUST PEEL OUT THE OLD ONE AND PASTE THE NEW ONE ON THE ARM. ARMPAD IS ADHESIVE ON THE BACK. PEEL OFF THE COVERED TAPE TO PASTE IT. (SEE FIG. 1)

REFER TO EXPENDABLE SUPPLIES BELOW TO ORDER THE PARTS.

<REPLACING THE PULLEY>

THE PULLEY HAS BALLBEARING IN IT. WHEN IT COMES TO ROTATE NOT SMOOTHLY, IT IS THE TIME TO REPLACE IT. REFER TO EXPENDABLE SUPPLIES BELOW TO ORDER THE PARTS.

1). FOR H81

FIRST, LOOSEN THE SCREW ON THE BELTARM AND WIDEN THE TOP AND BOTTOM PLATES. THEN, TAKE OUT THE PULLEY AND INSERT THE NEW ONE. (SEE FIG. 2)

CAUTION!: DO NOT WIDEN THE PLATES TOO MUCH. IT MAY BE DEFORMED.

2). FOR H821 (RUBBER BEARING FOR PULLEY)

TAKE OUT THE SCREW ① AT THE TOP OF THE ARM AND PULL THE PULLEY SHAFT ⑤ DOWN. THEN, THE RUBBER BEARING ④ CAN BE TAKEN OUT.

TO AMOUNT THE RUBBER BEARING, SANDWICH THE RUBBER BEARING BETWEEN THE SPACERS ③, THEN, PLACE THEM INTO THE TOP OF THE BELTARM.

FINALLY, INSERT THE PULLEY SHAFT FROM THE BOTTOM AND TIGHTEN THE SCREW ① WITH THE WASHER ②. (SEE FIG. 3)

5. EXPENDABLE SUPPLIES

THE TABLE FOR THE PARTS OF BELTARM IS BELOW. CONTACT WITH YOUR NEAREST DEALER TO ORDER. (SEE OUR GENERAL CATALOGUE FOR ABRASIVE BELTS.)

NAME	BELTARM	CODE NUMBER
ARMPAD	H 8 1	B S 1 - 2 7 2
	H 8 2	B S 1 - 2 7 3
PULLEY	H 8 1	B S 1 - 1 3 0
RUBBER BEARING	H 8 2	B S 3 1 - 1 0 5

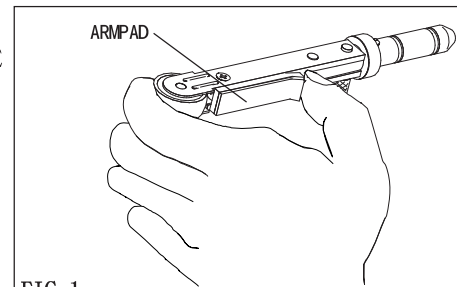

FIG. 1

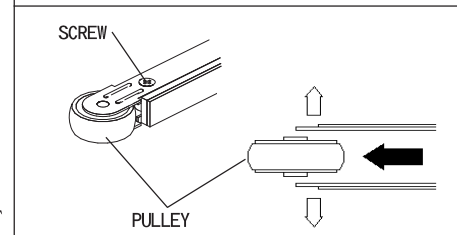

FIG. 2

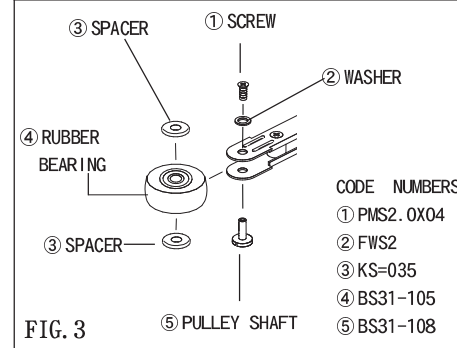

FIG. 3

- CODE NUMBERS
- ① PMS2.0X04
 - ② FWS2
 - ③ KS=035
 - ④ BS31-105
 - ⑤ BS31-108

MINITOR CO., LTD. JAPAN

Head Office : 16-3 Ryogoku 1-chome, Sumida-ku, Tokyo 130-0026 JAPAN

Phone 03-3633-7181 Fax 03-3633-7186

IDEAL FOR DE-BURRING, GRINDING AND POLISHING OF ALL TYPES OF MATERIALS.

1. PACKING LIST

- ◇ BS31 MINI BELTSANDER 1PC.
- ◇ H82 STANDARD BELTARM 1PC.
- ◇ ABRASIVE BELT #80 W=6mm (SA1011) . . . 1PC.
- ◇ CURLED CORD (CC711) 1PC.
- ◇ CARBON BRUSH (KE-580B) . . . 1SET (2PC.)

2. NAMES OF PARTS

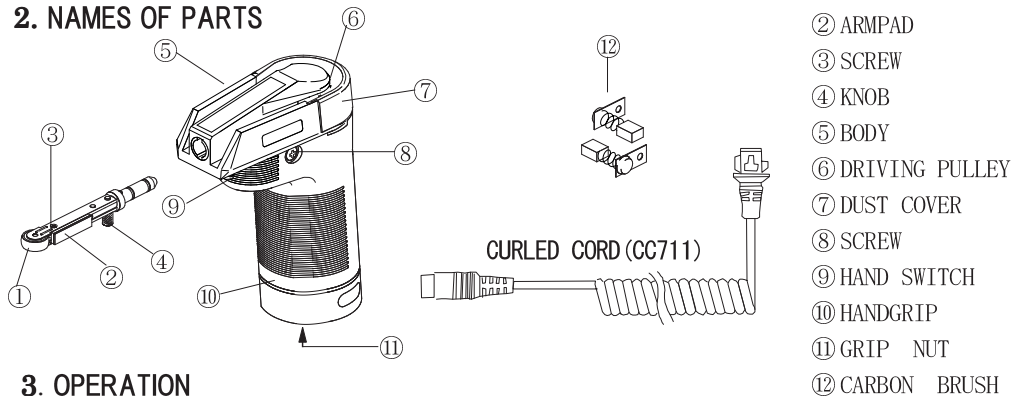

3. OPERATION

3-1. HAND SWITCH

PUSH THE HAND SWITCH ⑨ TO TURN ON, AND ANOTHER PUSH FOR TURNING OFF THE MOTOR.

- * THE HAND SWITCH WILL BE FUNCTIONED ONLY WITH CONNECTING THE UNIT TO OUR ONE SERIES AND SEVEN SERIES POWER PACK. ONE SERIES POWER PACKS ARE AS FOLLOWS:
C101, 111, 121, C301, 311, 321, P101, 111, 121, P201, 211, 221, C10M, C11M, C12M
- WHEN CONNECTING TO OUR SEVEN SERIES POWER PACKS, THE POWER SWITCH ON THE POWER PACK HAS TO BE AT "HANDPIECE" SIDE. (THE DETAIL IS ON THE SEVEN SERIES POWER PACK MANUAL.) THE SEVEN SERIES POWER PACKS ARE AS FOLLOWS:
C710, 711, 712, C730, 731, 732, P7101, 7111, 7121, C7301, 7311, 7321, P750, 751, 752
- * NEVER LET ANY LIQUID SUCH AS WATER, OIL AND SO ON, PENETRATES INTO THE SWITCH.

3-2. BELTARM

TO AMOUNT THE BELT
HOOK THE BELT AROUND THE DRIVE PULLEY
THEN, SQUEEZE THE KNOB, AND HOOK THE
OTHER SIDE OF THE BELT AROUND THE TOP PULLEY

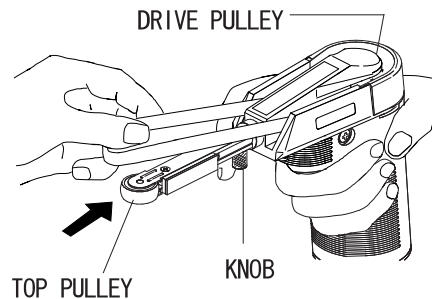

TO DISMOUNT THE BELT
SQUEEZE THE KNOB AND LIFT THE BELT UP TO
UNHOOK IT.

TO REPLACE THE BELTARM
AS DISMOUNTING THE BELT, JUST PULL STRAIGHT OUT
THE BELTARM, AND INSERT THE NEW ONE. (BE SURE
NOT TO BE UPSIDE DOWN.)

SEE THE FIGURE ON THE RIGHT.

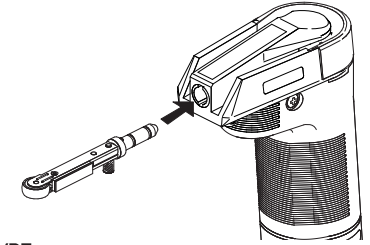

◇ WE HAVE TWO TYPES OF BELTARM. STANDARD AND THIN TYPE.

MODEL	WIDTH OF THE BELT	APPLICABLE
H 81 THIN BELTARM	CAN BE MOUNT THE BELT WITH 4mm AND 6mm WIDTH	BS 3 1 BS 3 7
H 82 STANDARD BELTARM	CAN BE MOUNT THE BELT WITH 6mm AND 8mm WIDTH	BS 3 6 BS 3 3

4. MAINTENANCE

<DRIVE PULLEY>

THE CHIPS AND DUST MAY COLLECT AROUND THE DRIVE PULLEY. (⑥ SEE NAMES OF PARTS ON THE PREVIOUS PAGE.) TAKE THE DUST COVER ⑦ AND CLEAN IT BY AIRBLOW OR VACUUM OUT.

<REPLACE THE CARBON BRUSHES>

WHEN THE CARBON BRUSHES ARE WORN OUT, THE MOTOR ROTATION MAY BECOME UNSTABLE OR EVEN BECOME NOT ROTATE AT ALL. IN THIS CASE, THE CARBON BRUSHES SHOULD BE REPLACED. WHEN REPLACING, BOTH SIDES OF THE CARBON BRUSHES SHOULD BE REPLACED WITH NEW ONES. THE STEPS TO REPLACE THE CARBON BRUSHES ARE AS FOLLOWS:

- ① UNPLUG THE CURLED CORD AND REMOVE SCREWS ON THE HANDGRIP AND THE GRIP NUT AT THE BOTTOM OF THE HANDGRIP BY THE SPANNER OF 19mm.
- ② TAKE OFF THE HANDGRIP AND REMOVE THE SCREWS ON THE BRUSH TERMINALS.
- ③ REPLACE THEM WITH NEW CARBON BRUSHES AND TIGHTEN THE SCREWS BACK.
- ④ PUT THE MOTOR HOUSING BACK IN THE HANDGRIP WITH CARE TO PLACE THE HANDSWITCH IN POSITION. THEN, TIGHTEN THE SCREWS AND GRIP NUT BACK.

